

Please rate this document after reviewing at the bottom of this page.

FUEL PRESSURE TEST (LOW PRESSURE SYSTEM)

1. Release the residual pressure in fuel line.

(Refer to the Fuel Delivery System - Inspection - "Release Residual Pressure in Fuel Line".)

CAUTION

When removing the fuel pump fuse, a Diagnostic Trouble Code (DTC) may occur. Delete the code with the KDS after completion of "Release Residual Pressure in Fuel Line" work.

2. Install the Special Service Tool (SST).

- (1) Disconnect the fuel feed tube from the delivery pipe.

CAUTION

There may be some residual pressure even after completing to "Release Residual Pressure in Fuel Line", so cover the hose connection with a shop towel to prevent residual fuel from spilling out before disconnecting any fuel connection.

- (2) Install the special service tool for measuring the fuel pressure in between the fuel feed tube and the fuel delivery pipe
(Refer to the figure below).

- For 09353-02100

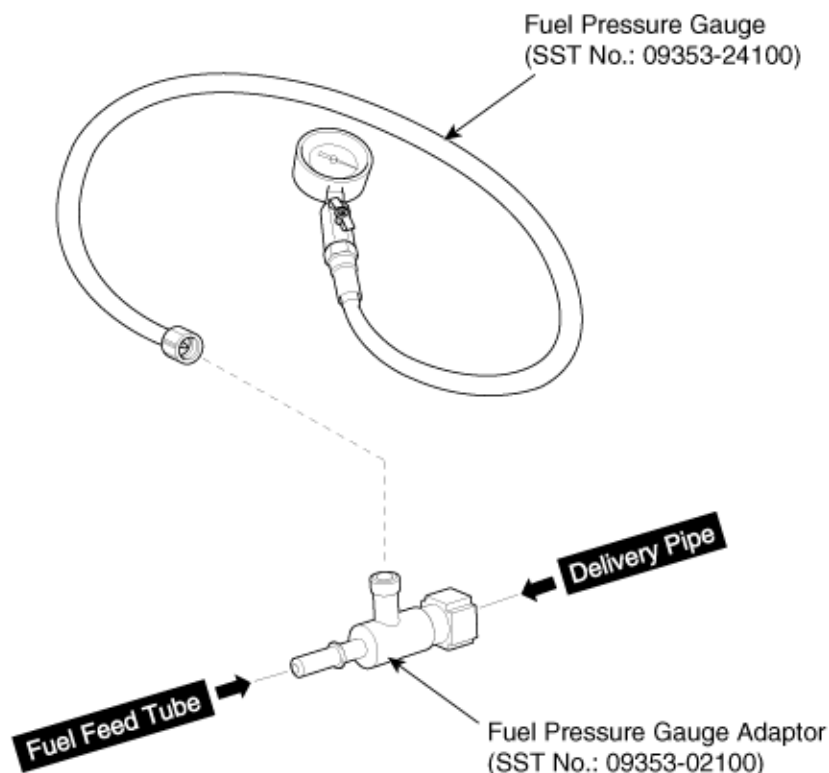

- For 0K353-D4100

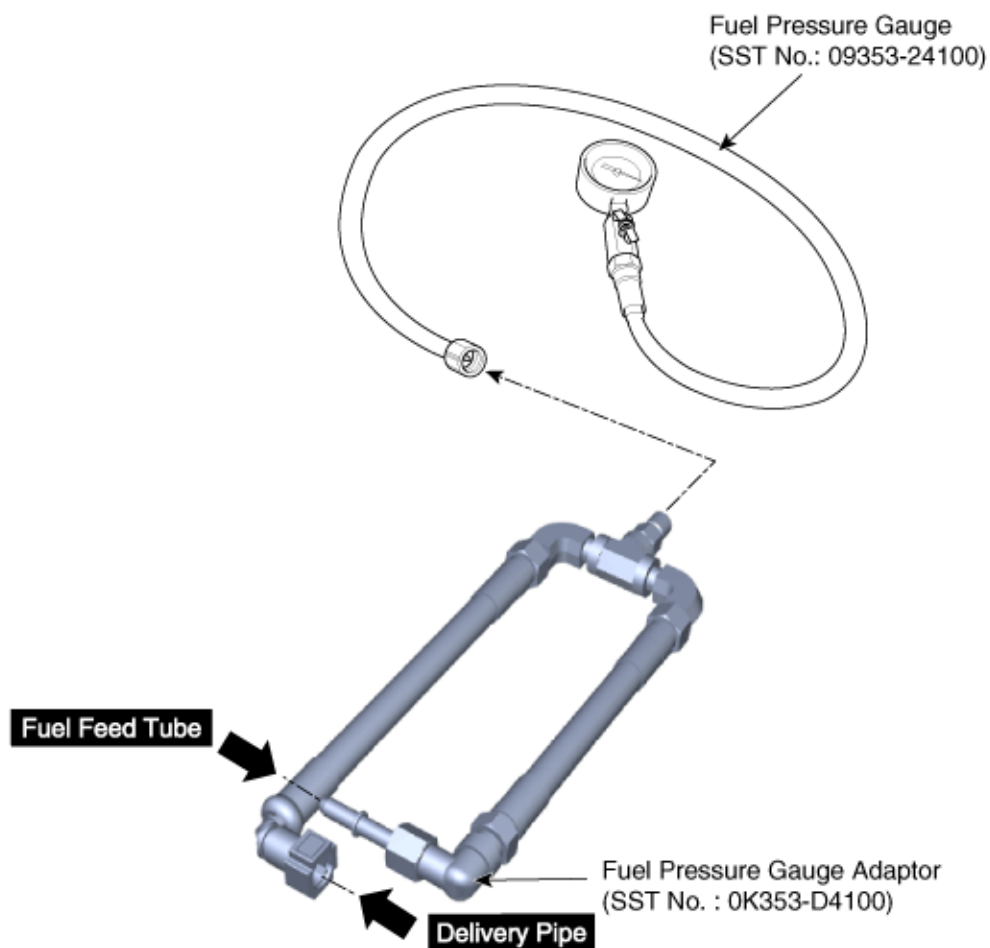

3. Inspect fuel leakage on connections among the fuel feed tube, the delivery pipe, and the SST components with ignition "ON".

4. Measure Fuel Pressure.

(1) Start the engine and measure the fuel pressure at idle.

Fuel Pressure: Over 290 kPa (Over 2.9 bar, Over 2.95 kgf/cm², Over 42.06 psi)

NOTICE

If the fuel pressure does not satisfy the specification, repair or replace the related part. (Refer to the table below.)

| Fuel Pressure | Cause | Related Part |
|---------------|-------------------------------|-------------------------|
| Too Low | Fuel filter clogged | Fuel Filter |
| | Fuel leakage | Fuel Pressure Regulator |
| Too High | Fuel pressure regulator stuck | Fuel Pressure Regulator |

(2) Stop the engine, and then check for the change in the fuel pressure gauge reading.

Standard Value: The gauge reading should hold for about 5 minutes after the engine stops

NOTICE

If the gauge reading could not be held, repair or replace the related part. (Refer to the table below.)

| Fuel Pressure (After Engine Stops) | Cause | Related Part |
|---------------------------------------|-------------------------------------|--------------|
| Fuel Pressure Drops Slowly | Leakage on injector | Injector |
| Fuel Pressure Drops Immediately | Check valve of fuel pump stuck open | Fuel Pump |

(3) Switch "OFF" the ignition.

English ▾

5. Release the residual pressure in fuel line.

(Refer to the Fuel Delivery System - Repair Procedures - "Release Residual Pressure in Fuel Line".)

⚠ CAUTION

When removing the fuel pump fuse, a Diagnostic Trouble Code (DTC) may occur. Delete the code with the KDS after completion of "Release Residual Pressure in Fuel Line" work.

6. Finish test.

(1) Remove the Special Service Tool (SST) from the low pressure fuel feed tube and the low pressure inlet of high pressure fuel pump.

(2) Connect the low pressure fuel feed tube and the low pressure inlet of high pressure fuel pump.

*** Thanks for your cooperation for the more quality. Please surely rate this document before closing.**